

# KITSAP MALL PLAZA

FOR LEASE - 1,777 SF TO 5,119 SF

3276 NW PLAZA RD | SILVERDALE, WA 98383



## LEASE INFORMATION

<b>Suite 106:</b>	1,777 SF
<b>Suite 107:</b>	3,342 SF
<b>Combined:</b>	5,119 SF
<b>Loading:</b>	1 GL Door (Suite 107)
<b>Lease Rate:</b>	Call Broker
<b>NNN Rate:</b>	Call Broker
<b>Available:</b>	6/1/2025

Suites can be combined for 5,119 SF

## PROPERTY FEATURES

- Located adjacent to Target
- Convenient vehicle cross-access and cross-shopping
- 1/4-mile from Hwy-3 on/off ramps
- Excellent visibility on NW Plaza Rd
- Across the street from the Kitsap Mall entrance
- Great visibility



**BRUCE VALENTINE**  
253.779.2400  
bvalentine@neilwalter.com

All information references in this document are approximate. The information contained herein is contained from sources deemed reliable. It is provided without representation, warranty, or guarantee, expressed or implied as to accuracy. Prospective buyer or tenant should conduct its own independent investigation relating to the property, government codes and regulations, allowed uses, and all other matters, regardless of whether they are referred to or contained in this document.

# KITSAP MALL PLAZA

3276 NW PLAZA RD | SILVERDALE, WA 98383

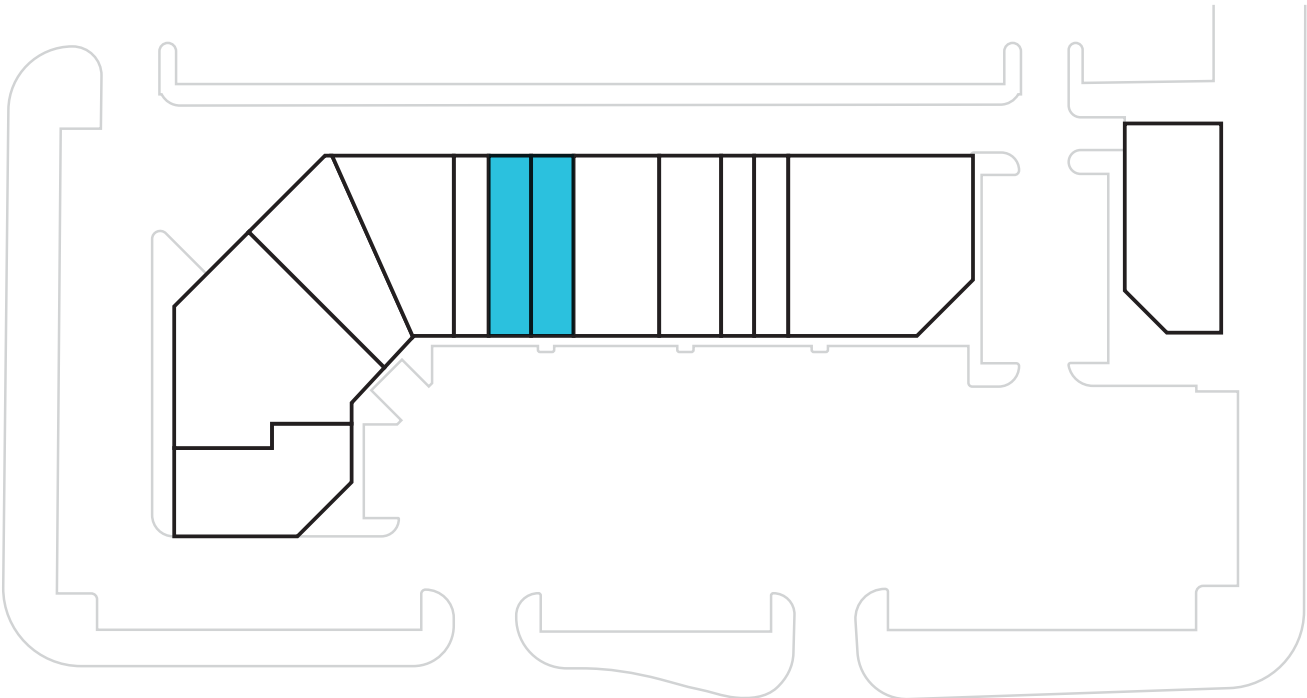

**BRUCE VALENTINE**  
253.779.2400

bvalentine@neilwalter.com

1940 East D St #100  
Tacoma, WA 98421  
253.779.8400

www.neilwalter.com

All information references in this document are approximate. The information contained herein is contained from sources deemed reliable. It is provided without representation, warranty, or guarantee, expressed or implied as to accuracy. Prospective buyer or tenant should conduct its own independent investigation relating to the property, government codes and regulations, allowed uses, and all other matters, regardless of whether they are referred to or contained in this document.