

# RIVERWOOD PLAZA

FOR SALE: \$2,400,000

21505 SE RENTON MAPLE VALLEY RD | MAPLE VALLEY, WA 98038

## RETAIL BUILDING - INVESTOR OR OWNER/USER OPPORTUNITY



### SALE INFORMATION

- Sale Price: \$2,400,000
- 8,320 SF multi-tenant retail/office building
- Suitable for an investor or owner/user
- Currently occupied by 4 tenants
- Office/retail space and industrial shop with 3 roll-up doors
- Up to 2,400 SF currently available for lease
- Current 5.59% cap rate
- Located on 1.26 acres (55,192 SF) with 15% site coverage
- Ample parking available

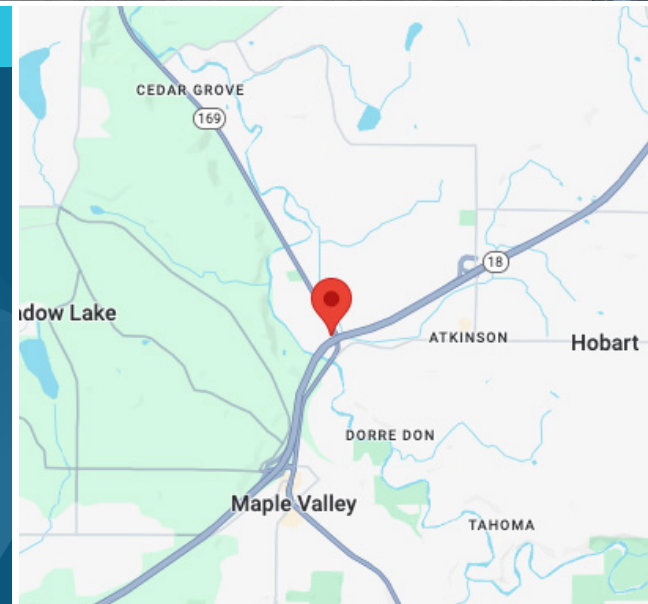

**BRUCE HEMMAT**  
303.995.3215

bhemmat@neilwalter.com

**JIM HONAN**  
206.399.7649

jhonan@neilwalter.com

All information references in this document are approximate. The information contained herein is contained from sources deemed reliable. It is provided without representation, warranty, or guarantee, expressed or implied as to accuracy. Prospective buyer or tenant should conduct its own independent investigation relating to the property, government codes and regulations, allowed uses, and all other matters, regardless of whether they are referred to or contained in this document.

# RIVERWOOD PLAZA

21505 SE RENTON MAPLE VALLEY RD | MAPLE VALLEY, WA 98038

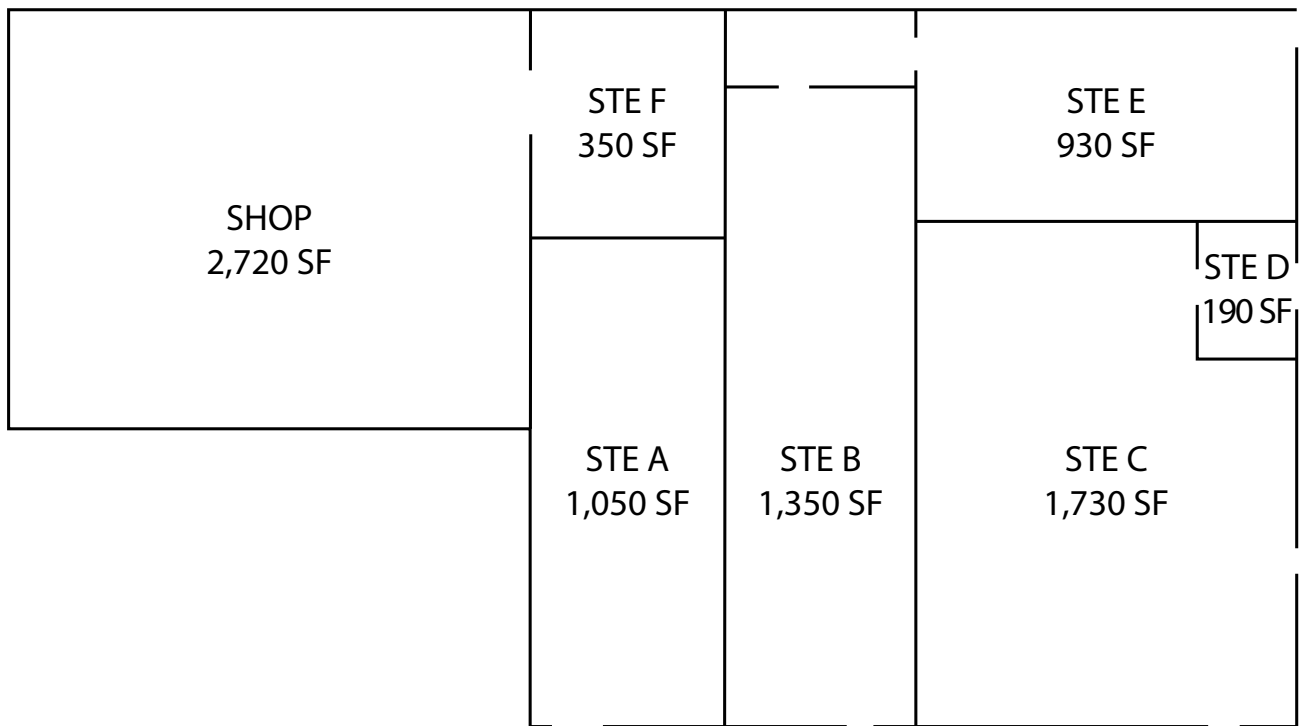

**BRUCE HEMMAT**  
303.995.3215  
bhemmat@neilwalter.com

**JIM HONAN**  
206.399.7649  
jhonan@neilwalter.com

550 S Michigan St  
Seattle, WA 98108  
206.787.1800  
www.neilwalter.com

All information references in this document are approximate. The information contained herein is contained from sources deemed reliable. It is provided without representation, warranty, or guarantee, expressed or implied as to accuracy. Prospective buyer or tenant should conduct its own independent investigation relating to the property, government codes and regulations, allowed uses, and all other matters, regardless of whether they are referred to or contained in this document.

# RIVERWOOD PLAZA

21505 SE RENTON MAPLE VALLEY RD | MAPLE VALLEY, WA 98038



**BRUCE HEMMAT**  
303.995.3215  
bhemmat@neilwalter.com

**JIM HONAN**  
206.399.7649  
jhonan@neilwalter.com

550 S Michigan St  
Seattle, WA 98108  
206.787.1800  
www.neilwalter.com

All information references in this document are approximate. The information contained herein is contained from sources deemed reliable. It is provided without representation, warranty, or guarantee, expressed or implied as to accuracy. Prospective buyer or tenant should conduct its own independent investigation relating to the property, government codes and regulations, allowed uses, and all other matters, regardless of whether they are referred to or contained in this document.