

# KENT CORPORATE PARK

FOR LEASE: 4,369 SF & 9,783 SF

22412-22426 72ND AVE S | KENT, WA

## KENT VALLEY WAREHOUSE SPACES AVAILABLE



### SUITE D-22426 LEASE INFO

<b>Available Size:</b>	9,783 SF (Total) 792 SF (Office)
<b>Loading Doors:</b>	3 dock-high doors 1 grade-level door
<b>Column Spacing:</b>	48' x 21'
<b>Power:</b>	1-100 Amp panel 1-50 Amp panel 1-100 Amp, 3-phase panel
<b>Clear Height:</b>	24'
<b>Available:</b>	12/1/2024

### SUITE C-22416 LEASE INFO

<b>Available Size:</b>	4,369 SF (Total) 721 SF (Office)
<b>Loading Doors:</b>	2 dock-high doors 1 grade-level door
<b>Clear Height:</b>	18'
<b>Available:</b>	10/4/2024



South Sound Industrial | Property Group

**JOEL JONES**  
D: 253.779.2422  
C: 253.219.9914  
jjones@neilwalter.com

**SCOTT PRICE**  
D: 253.779.2419  
C: 253.279.3710  
sprice@neilwalter.com



All square footage references are approximate. The information contained herein is from sources deemed reliable. Prospective Buyer or Tenant should conduct an independent investigation and verification of all matters.

# KENT CORPORATE PARK

22412-22426 72ND AVE S | KENT, WA



## BUILDING D-22426 9,783 SF Total | 792 SF Office

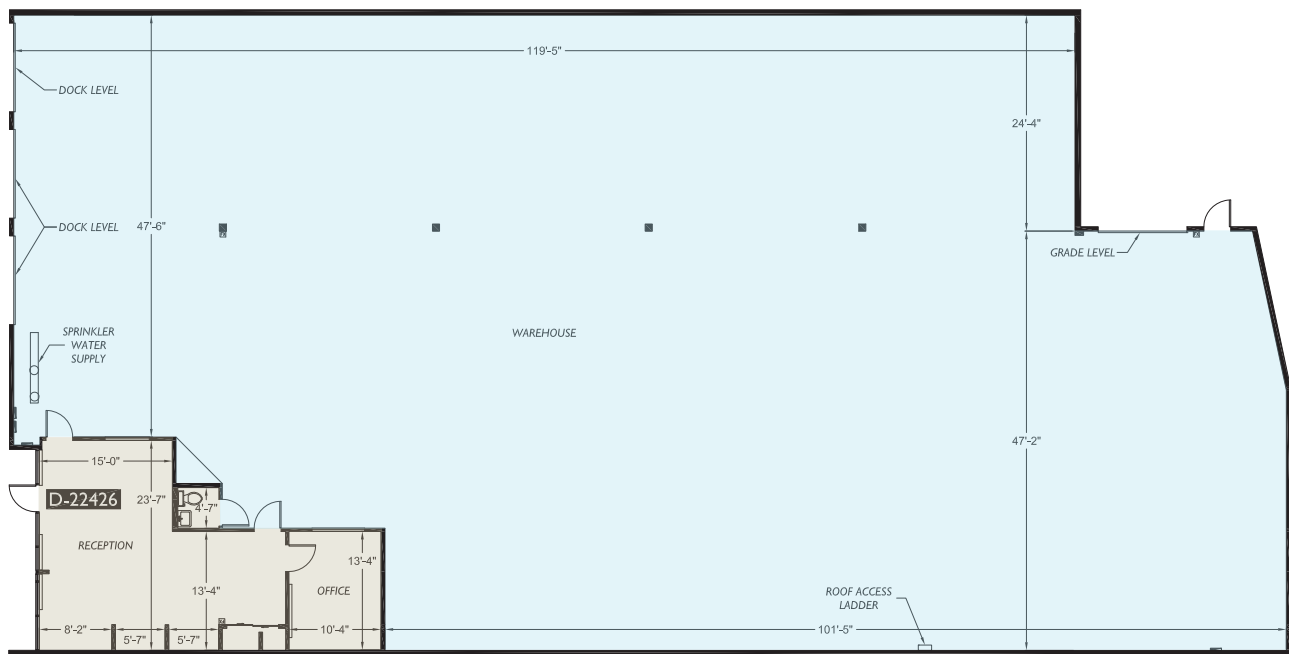

South Sound Industrial | Property Group

**JOEL JONES**  
D: 253.779.2422  
C: 253.219.9914  
jjones@neilwalter.com

**SCOTT PRICE**  
D: 253.779.2419  
C: 253.279.3710  
sprice@neilwalter.com



All square footage references are approximate. The information contained herein is from sources deemed reliable. Prospective Buyer or Tenant should conduct an independent investigation and verification of all matters.

# KENT CORPORATE PARK

22412-22426 72ND AVE S | KENT, WA



## BUILDING C-22416 4,369 SF Total | 921 SF Office

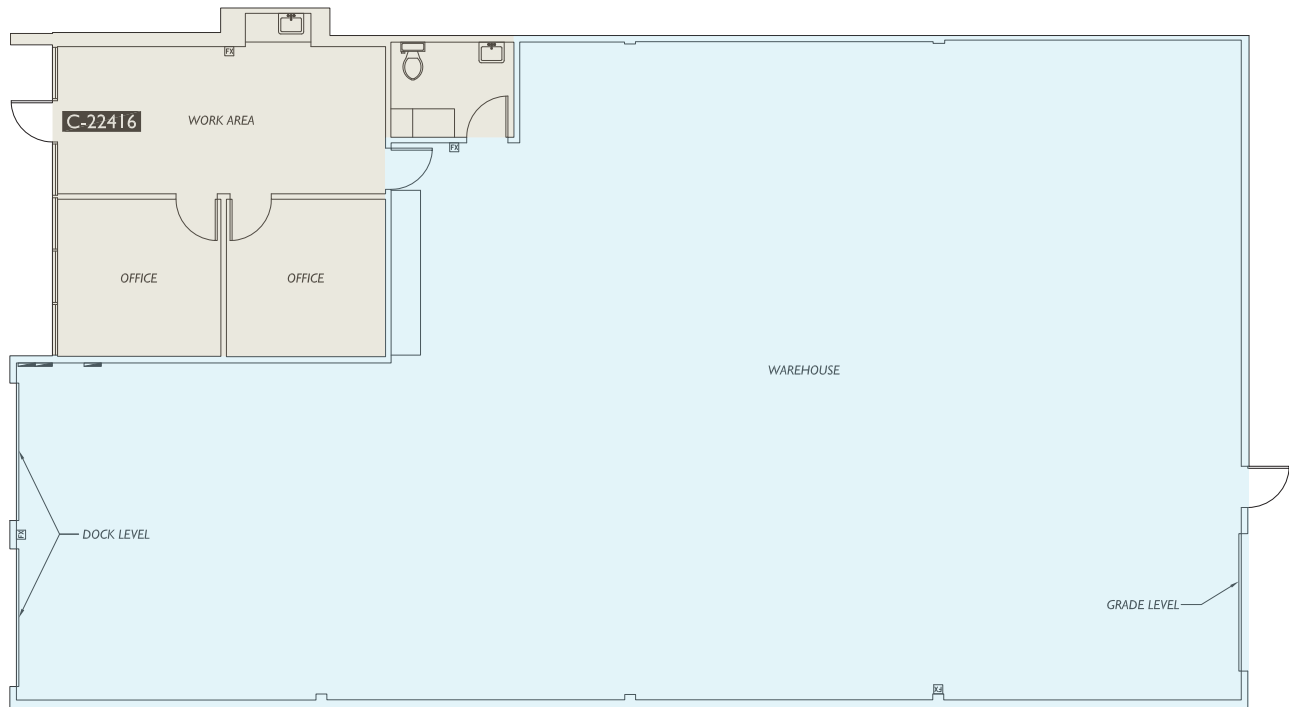

South Sound Industrial | Property Group

**JOEL JONES**  
D: 253.779.2422  
C: 253.219.9914  
jjones@neilwalter.com

**SCOTT PRICE**  
D: 253.779.2419  
C: 253.279.3710  
sprice@neilwalter.com



All square footage references are approximate. The information contained herein is from sources deemed reliable. Prospective Buyer or Tenant should conduct an independent investigation and verification of all matters.



# KENT CORPORATE PARK

22412-22426 72ND AVE S | KENT, WA

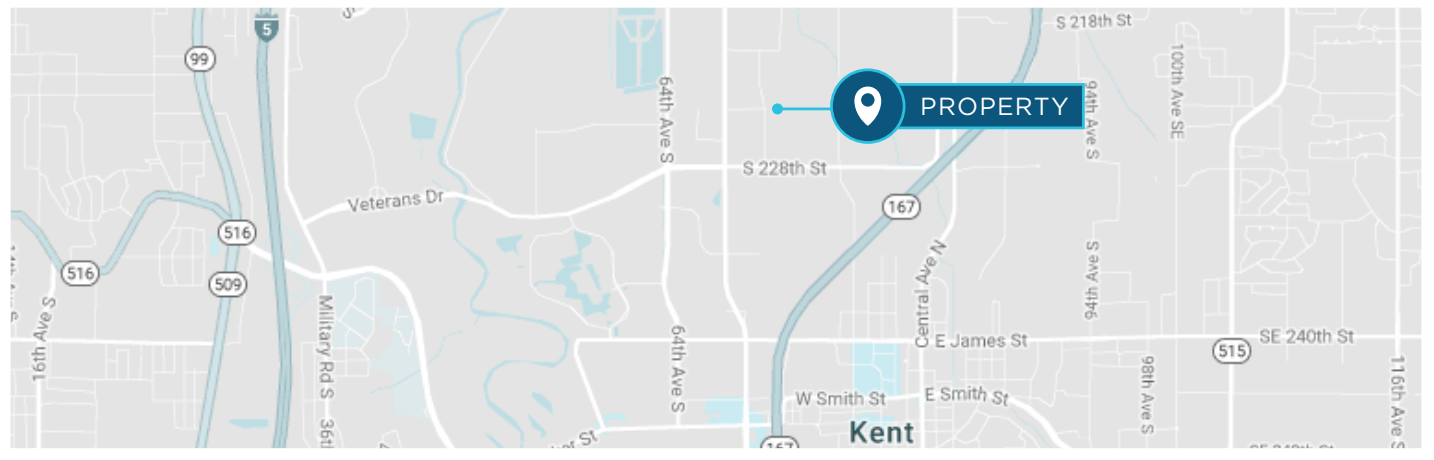

South Sound Industrial | Property Group

**JOEL JONES**

D: 253.779.2422

C: 253.219.9914

[jjones@neilwalter.com](mailto:jjones@neilwalter.com)

**SCOTT PRICE**

D: 253.779.2419

C: 253.279.3710

[sprice@neilwalter.com](mailto:sprice@neilwalter.com)



All square footage references are approximate. The information contained herein is from sources deemed reliable. Prospective Buyer or Tenant should conduct an independent investigation and verification of all matters.