

# CASCADE BUILDING

2316 SOUTH STATE STREET | TACOMA, WA 98405

FOR LEASE

2 UNITS  
AVAILABLE

## CENTRALLY LOCATED OFFICE AND WAREHOUSE SPACE



### OFFICE/WAREHOUSE

<b>Available:</b>	15,000 SF Total
<b>Office Size:</b>	± 2,500 SF
<b>Lease Rate:</b>	\$1.00/SF/Month
<b>Lease Type:</b>	Gross
<b>Loading:</b>	1GL & 1 DH
<b>Clear Height:</b>	20'
<b>Column Spacing:</b>	20'x48'
<b>Yard:</b>	5,200 SF Available (\$0.25/SF)

### OFFICE SPACE

<b>Available:</b>	1,600 SF (on 2nd floor)
<b>Lease Rate:</b>	\$16/SF/Year
<b>Lease Type:</b>	Modified Gross



### LOCATION HIGHLIGHTS

- Located between Allenmore, St. Joseph's & Tacoma General hospitals
- Excellent freeway access - just minutes from Hwy-16 and I-5
- Close proximity to downtown Tacoma or Port of Tacoma



**CHRIS HIGHSMITH**  
253 779 2402  
chighsmith@neilwalter.com

**JOEL JONES**  
253 779 2422  
jjones@neilwalter.com

# CASCADE BUILDING



2316 SOUTH STATE STREET | TACOMA, WA 98405

NEIL WALTER  
COMPANY



OFFICE/  
WAREHOUSE  
SPACE  
15,000 SF

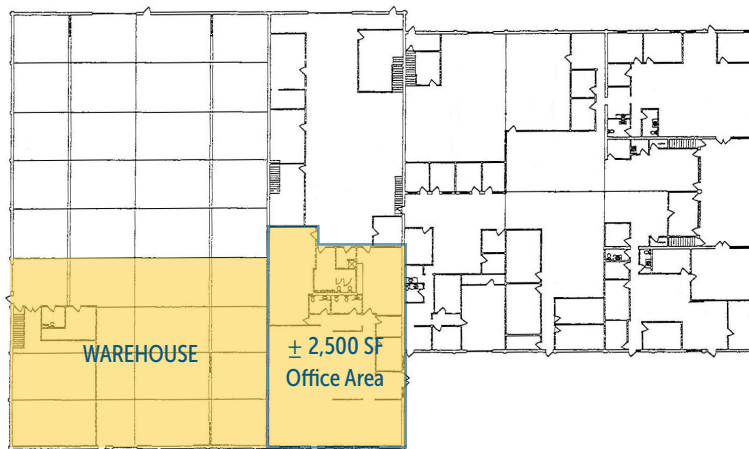

All square footage references are approximate. The information contained herein is from sources deemed reliable. It is provided without representation, warranty or guarantee, expressed or implied as to its accuracy. Prospective Buyer or Tenant should conduct an independent investigation of all matters.

**CHRIS HIGHSMITH**  
253 779 2402  
chighsmith@neilwalter.com

**JOEL JONES**  
253 779 2422  
jjones@neilwalter.com

1940 East D St #100  
Tacoma, WA 98421

253.779.8400  
www.neilwalter.com