

KENYON BUSINESS PARK

FOR LEASE: 21,220 SF

S KENYON ST & OCCIDENTAL AVE S | SEATTLE, WA 98108

SOUTH SEATTLE WAREHOUSE SPACE



Kenyon Business Park is a four building, 127,889 square foot business park with superior visibility located along SR-509 in Seattle. Ideal for shipping and receiving, Kenyon Business Park offers close proximity access to the Port of Seattle, SeaTac Airport, Downtown Seattle I-5 and the Kent Valley.



PROPERTY FEATURES

Great access to
SR-509,
SR-99 & I-5

±20'
Clear Height

Dock &
Grade Loading

Ownership-
Management
Office Located
Nearby

SPENCER MEAD
206.787.1476
smead@neilwalter.com

JIM HONAN
206.787.1464
jhonan@neilwalter.com



professionally
managed/owned by:



All information references in this document are approximate. The information contained herein is contained from sources deemed reliable. It is provided without representation, warranty, or guarantee, expressed or implied as to accuracy. Prospective buyer or tenant should conduct its own independent investigation relating to the property, government codes and regulations, allowed uses, and all other matters, regardless of whether they are referred to or contained in this document.

KENYON BUSINESS PARK

S KENYON ST & OCCIDENTAL AVE S | SEATTLE, WA 98108



Current Lease Opportunities

Building	Unit(s)	Total SF	Office SF	Loading	Power
D	7951 & 7952	21,220 SF	1,871 SF	5 GL Doors 1 Truck Well	600 amps, 480v, 3-phase

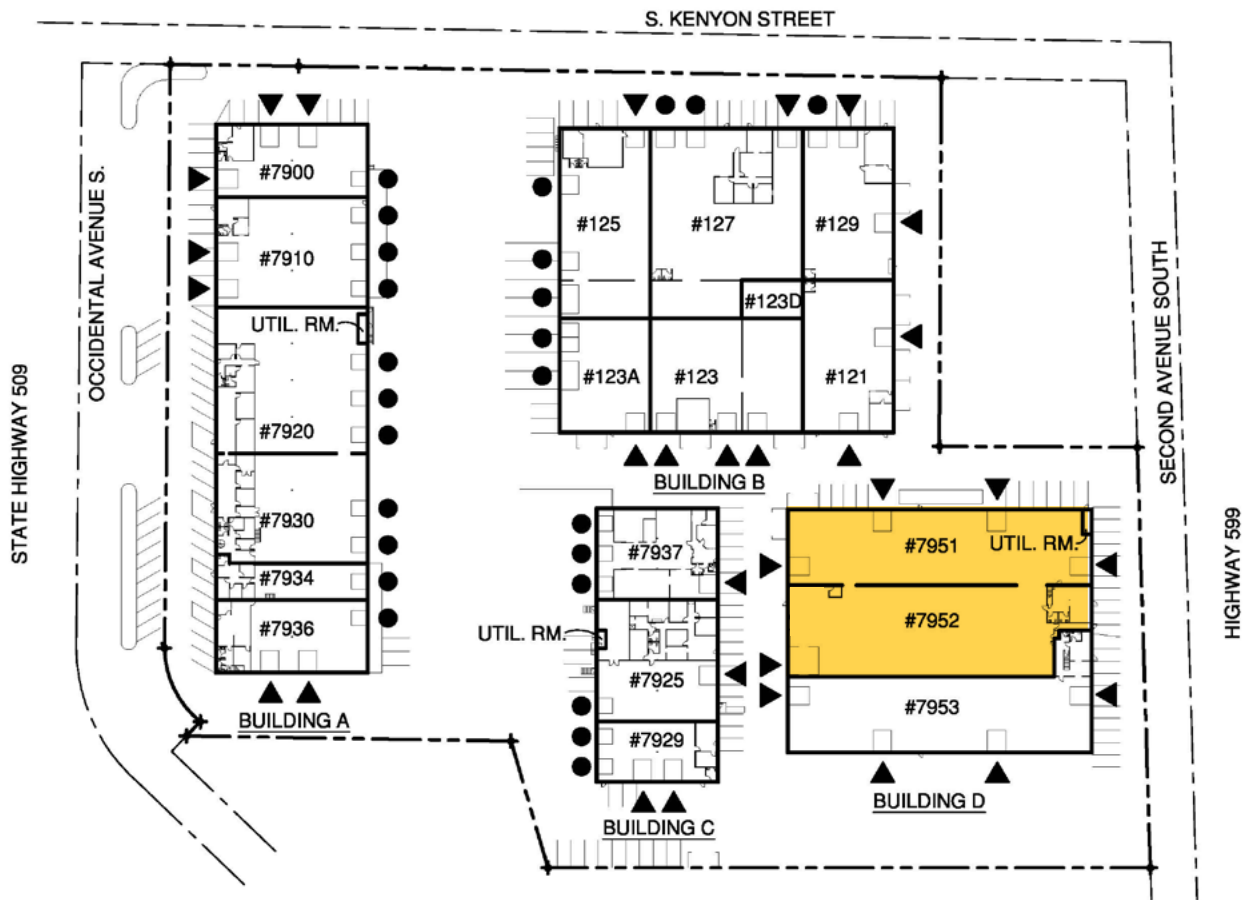

SPENCER MEAD
206.787.1476
smead@neilwalter.com

JIM HONAN
206.787.1464
jhonan@neilwalter.com

550 S Michigan St
Seattle, WA 98108
206.787.1800
www.neilwalter.com

All information references in this document are approximate. The information contained herein is contained from sources deemed reliable. It is provided without representation, warranty, or guarantee, expressed or implied as to accuracy. Prospective buyer or tenant should conduct its own independent investigation relating to the property, government codes and regulations, allowed uses, and all other matters, regardless of whether they are referred to or contained in this document.

KENYON BUSINESS PARK

S KENYON ST & OCCIDENTAL AVE S | SEATTLE, WA 98108



Building D Lease Opportunity

Unit(s)	Total SF	Loading	Power
7951 & 7952	21,220 SF	5 GL Doors; 1 Truck Well	600 amps, 480v, 3-phase

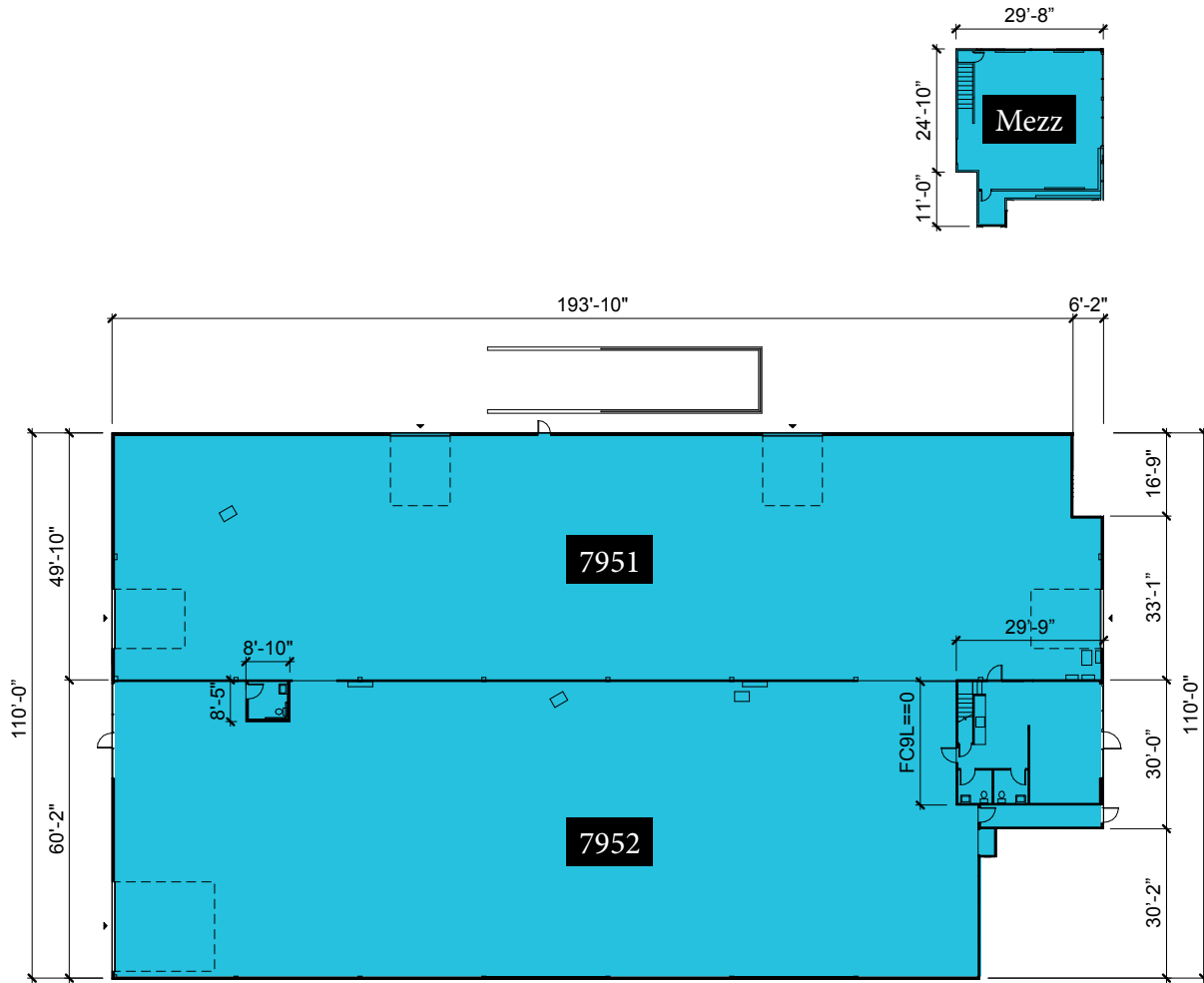

Click or Scan for Virtual Tour



SPENCER MEAD
206.787.1476
smead@neilwalter.com

JIM HONAN
206.787.1464
jhanon@neilwalter.com

550 S Michigan St
Seattle, WA 98108
206.787.1800
www.neilwalter.com

All information references in this document are approximate. The information contained herein is contained from sources deemed reliable. It is provided without representation, warranty, or guarantee, expressed or implied as to accuracy. Prospective buyer or tenant should conduct its own independent investigation relating to the property, government codes and regulations, allowed uses, and all other matters, regardless of whether they are referred to or contained in this document.

KENYON BUSINESS PARK

S KENYON ST & OCCIDENTAL AVE S | SEATTLE, WA 98108

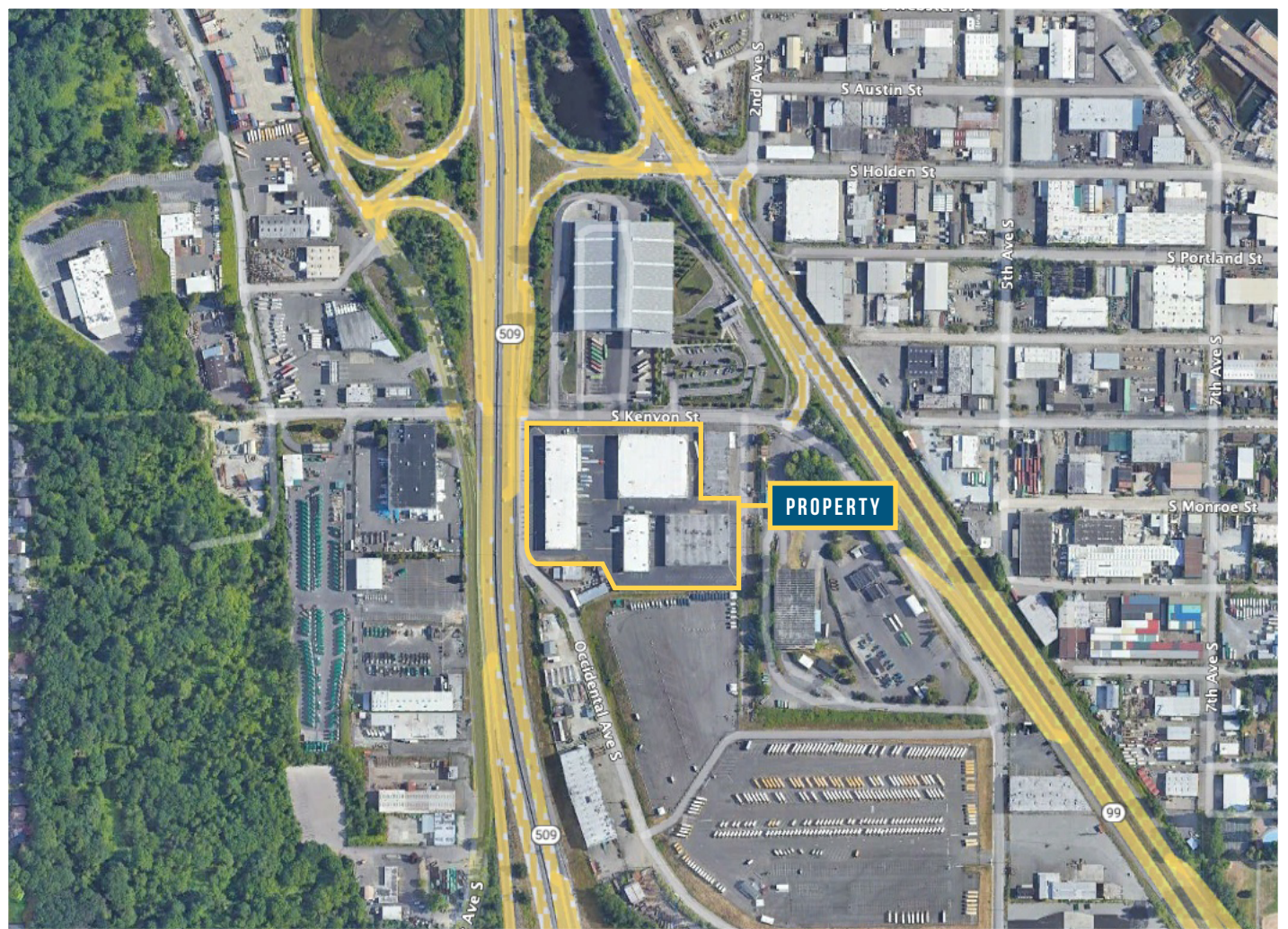

SPENCER MEAD
206.787.1476
smead@neilwalter.com

JIM HONAN
206.787.1464
jhonan@neilwalter.com

550 S Michigan St
Seattle, WA 98108
206.787.1800
www.neilwalter.com

All information references in this document are approximate. The information contained herein is contained from sources deemed reliable. It is provided without representation, warranty, or guarantee, expressed or implied as to accuracy. Prospective buyer or tenant should conduct its own independent investigation relating to the property, government codes and regulations, allowed uses, and all other matters, regardless of whether they are referred to or contained in this document.